

The Queen's House

This beautiful royal palace completed for Charles I's queen, Henrietta Maria, features the National Maritime Museum's world-class collection of paintings.

Built between 1616 and 1638 as England's first truly classical building, Inigo Jones's Palladian masterpiece features the elegant Tulip Stairs and the awe-inspiring Great Hall, a perfect 40 foot cube.

Use this floor map to plan your visit. Architectural and audio guides are available at the information desk to enhance your visit.



Floor one

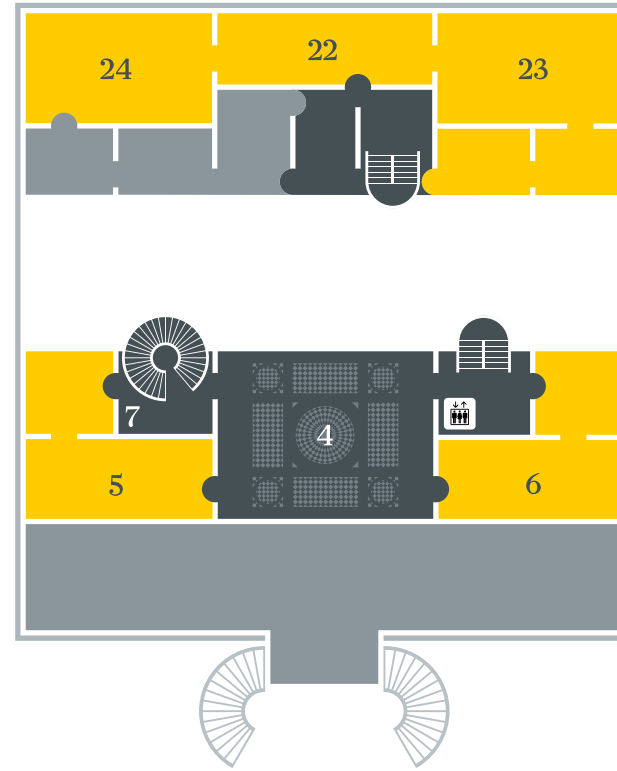

Floor two

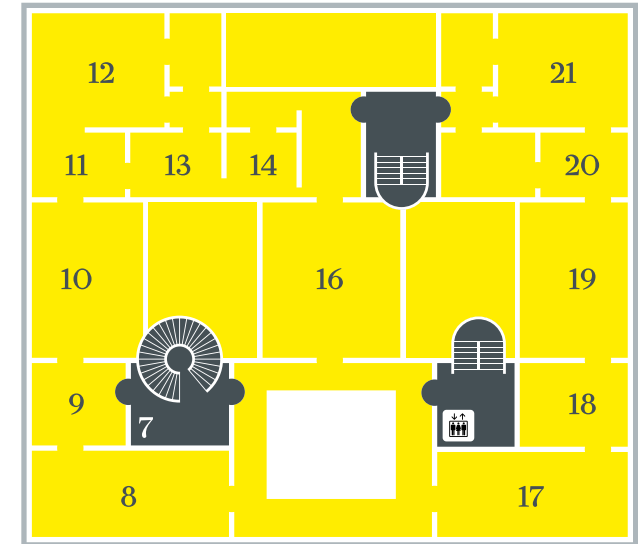

Ground floor

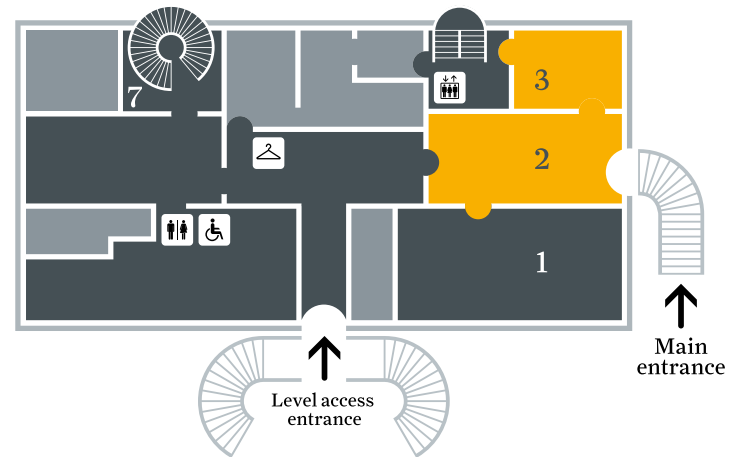

- | | | | |
|--|--|--|---------------------|
| | Cloakroom | | Toilets |
| | Lift | | Accessible toilet |
| | Learning space | | Tudors at Greenwich |
| | The history of the House and the Royal Hospital School | | Tulip Stairs |
| | Cradle of the Navy | | Art for the Nation |
| | Great Hall | | Orangery |
| | Historic Greenwich | | South-west Parlour |
| | | | South-east Parlour |