

Cut around Elizabeth, including her hands hair and her feet.  
You will be able to attach each dress by folding the tabs.

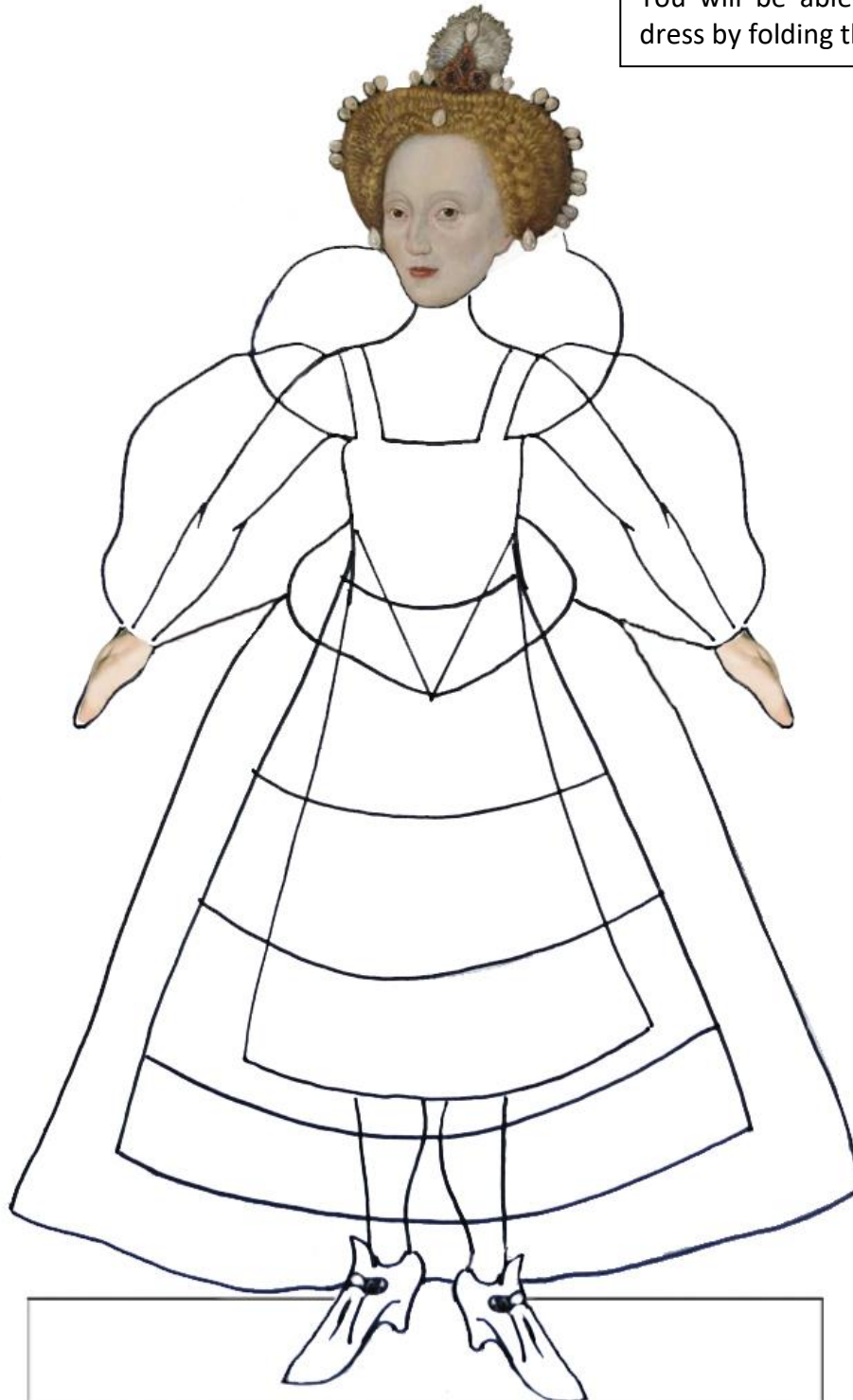

Cut around the box (with her feet) and stick to a toilet-roll tube to help her stand.

Cut around the black lines, not forgetting the tabs, as you will use these to fold around Elizabeth.

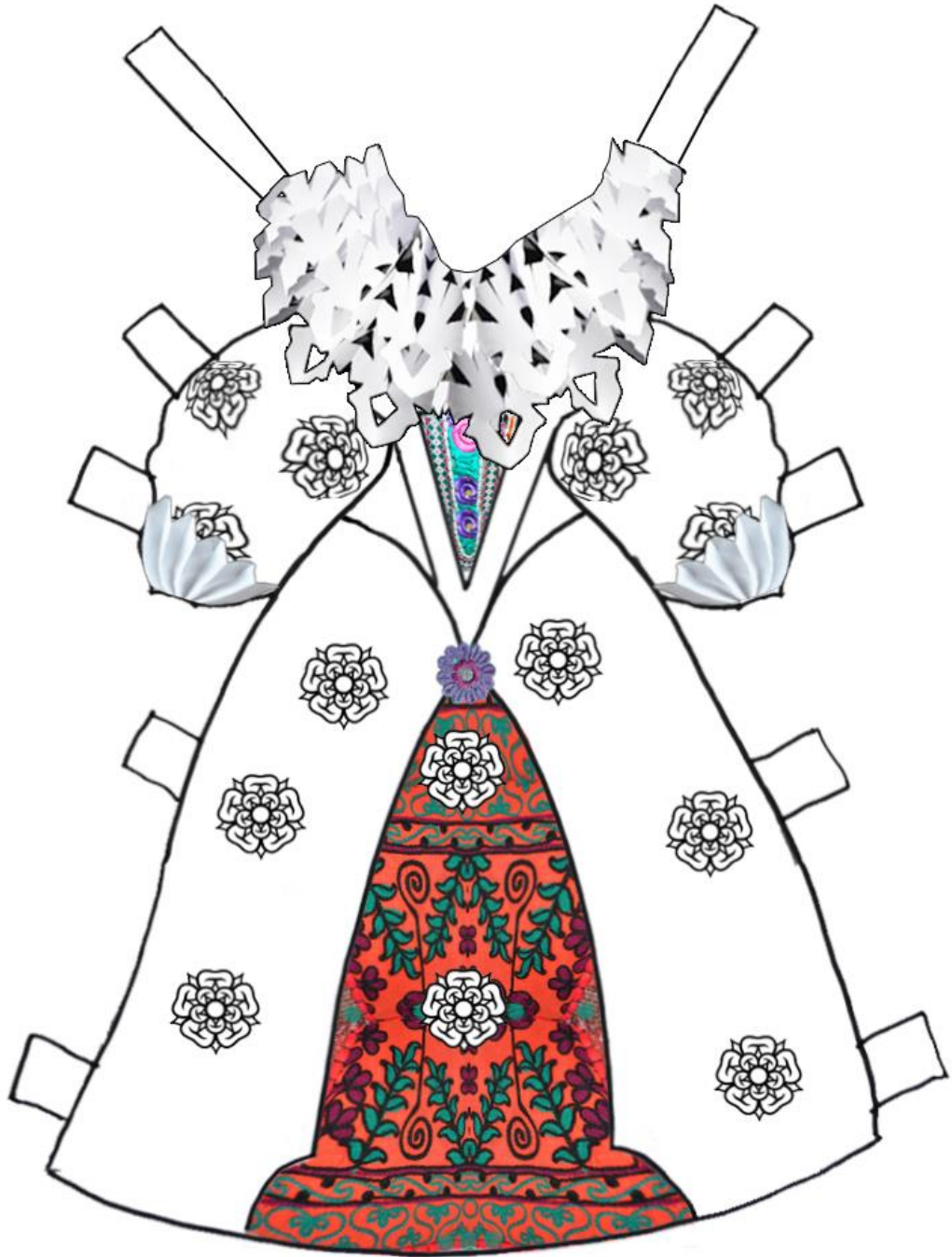

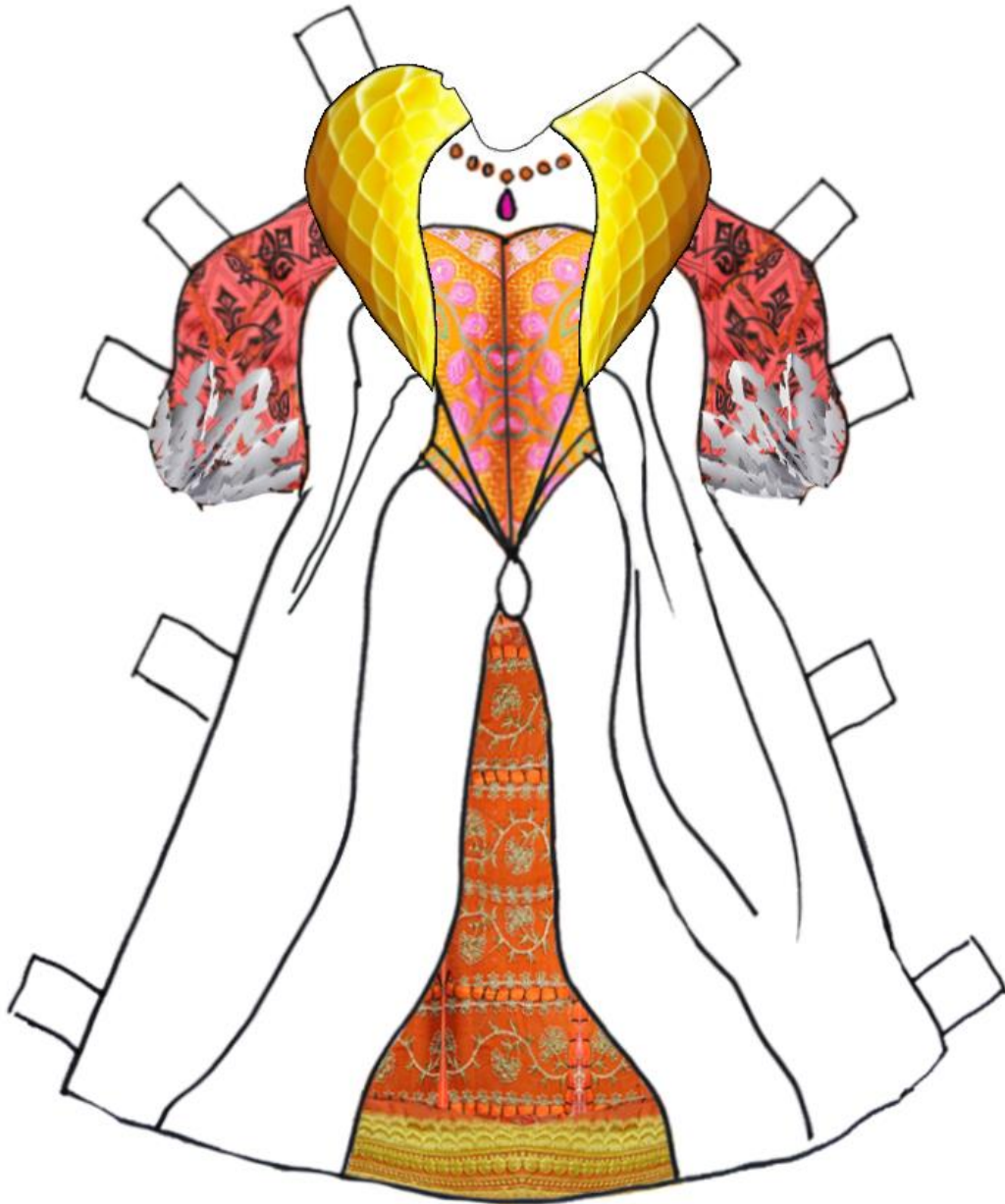

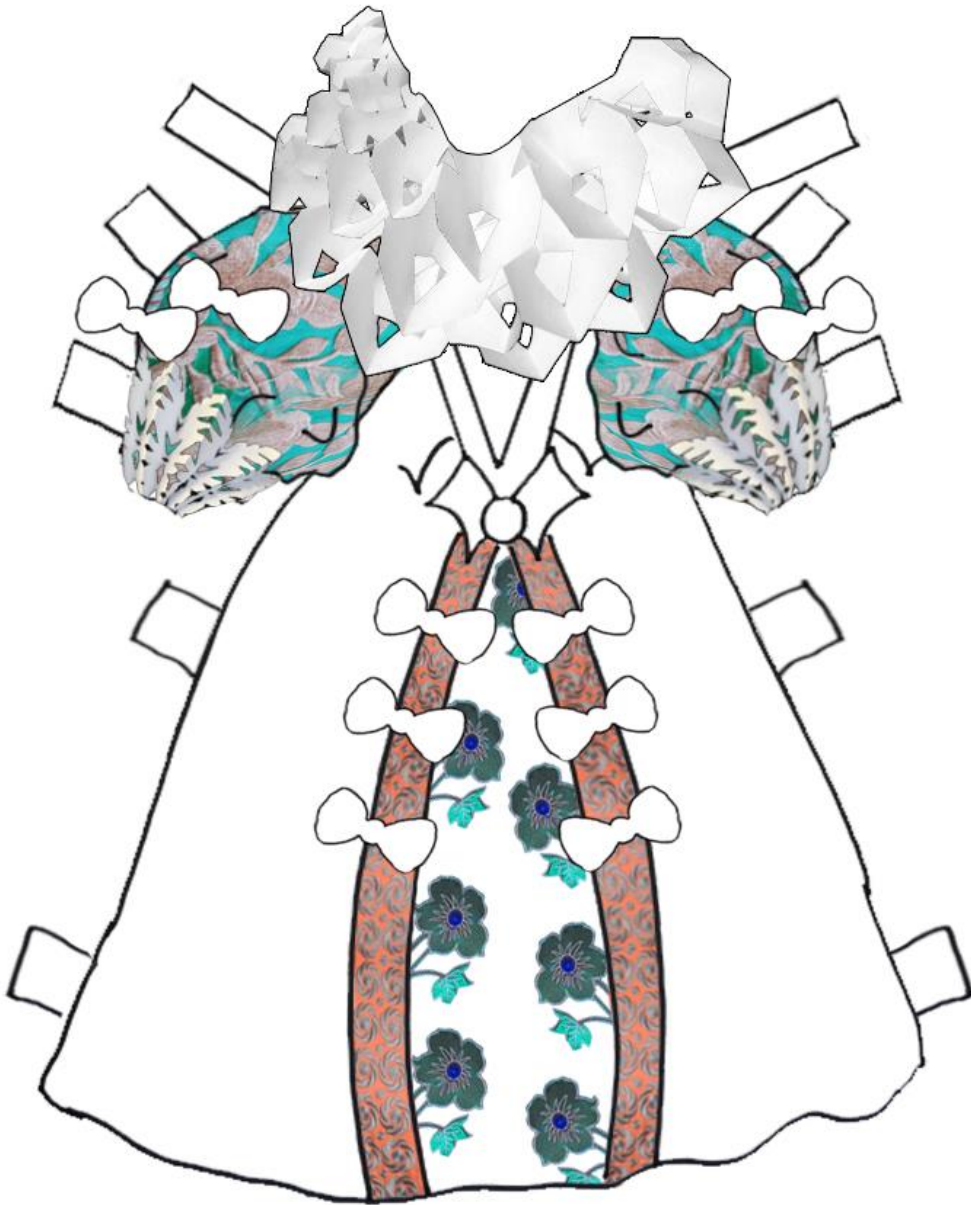

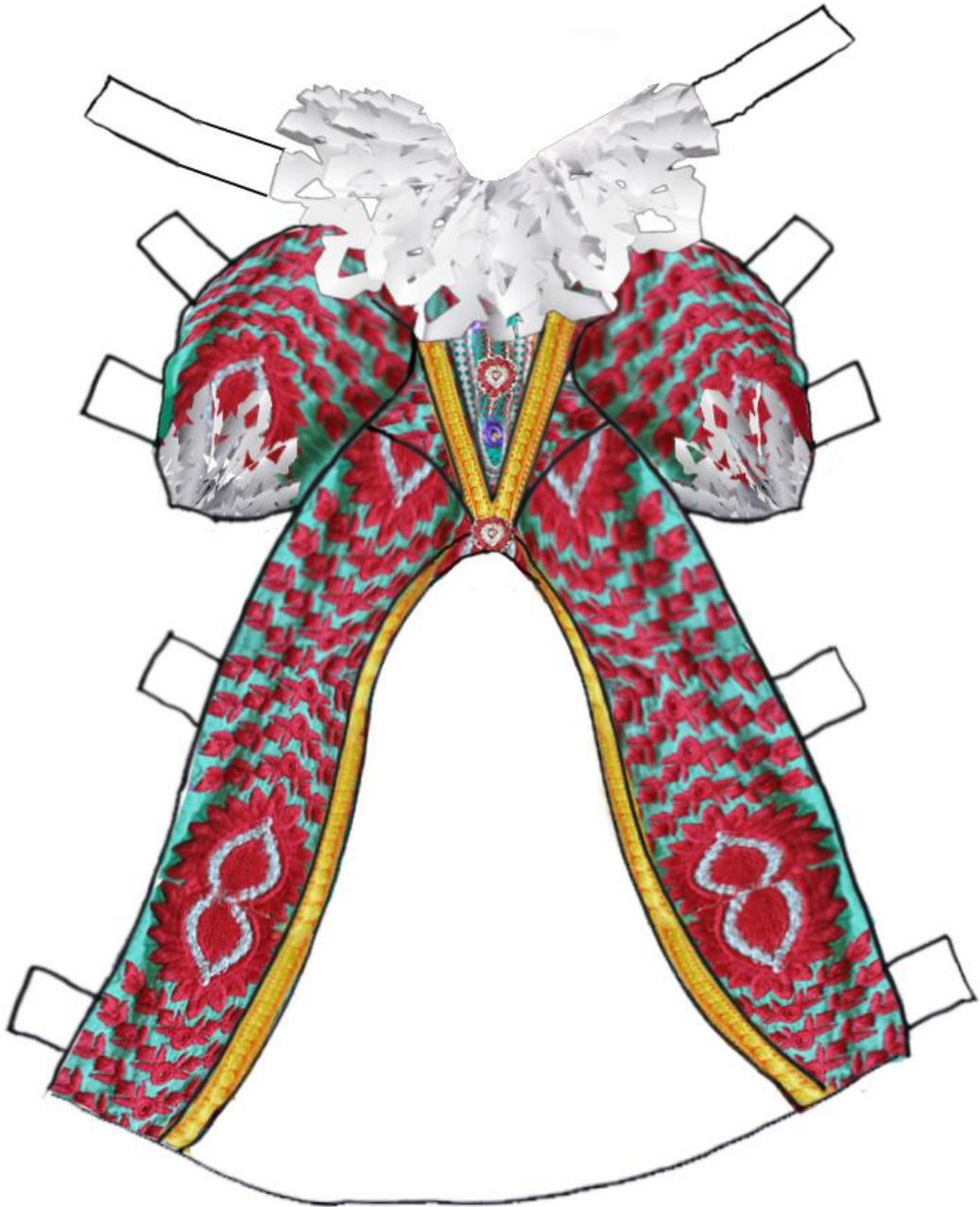

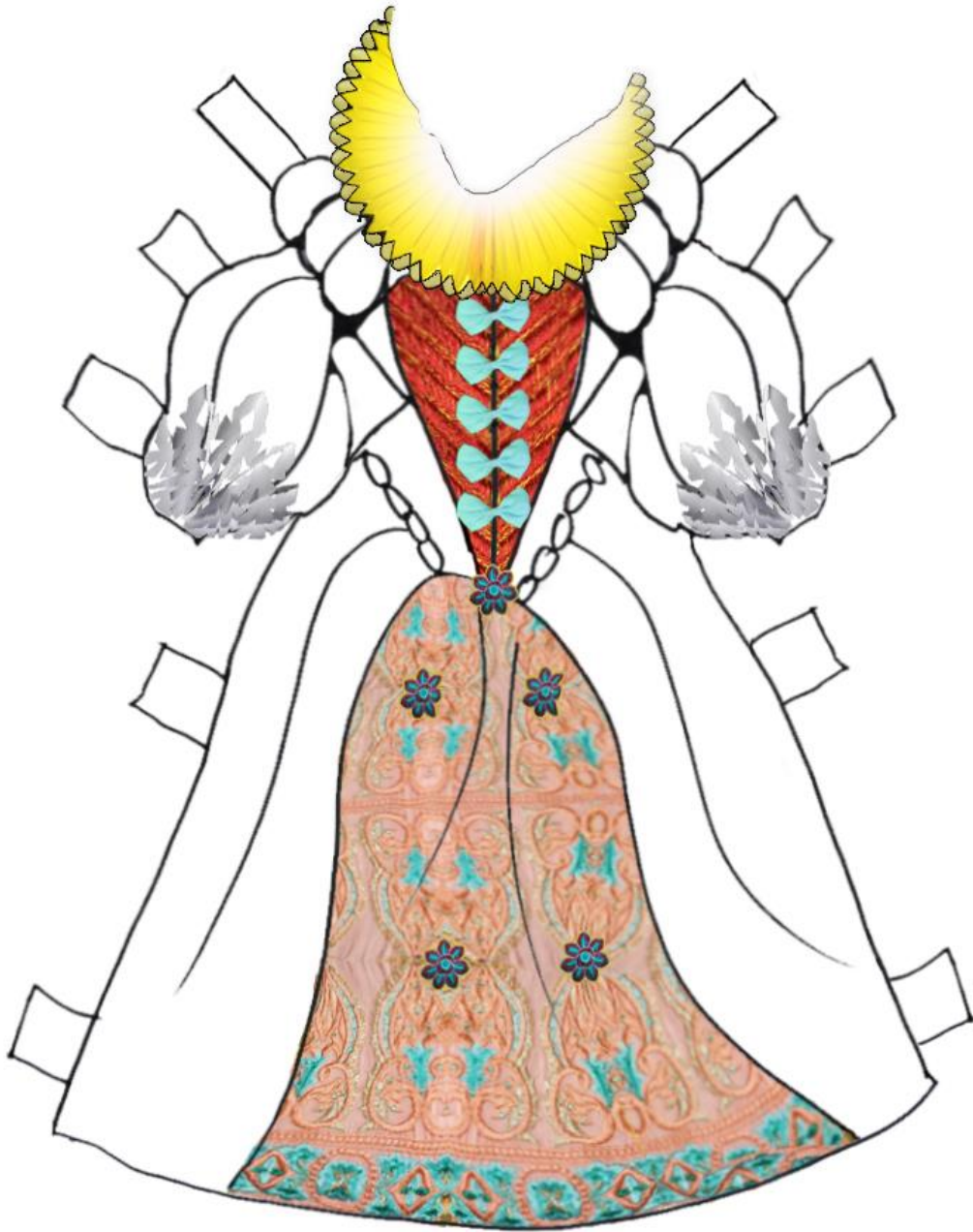

Cut the grey criss-cross areas.  
In order to cut sections in the  
middle of a piece of paper, make  
a small fold in the area you want  
to cut and snip to make a small  
hole.

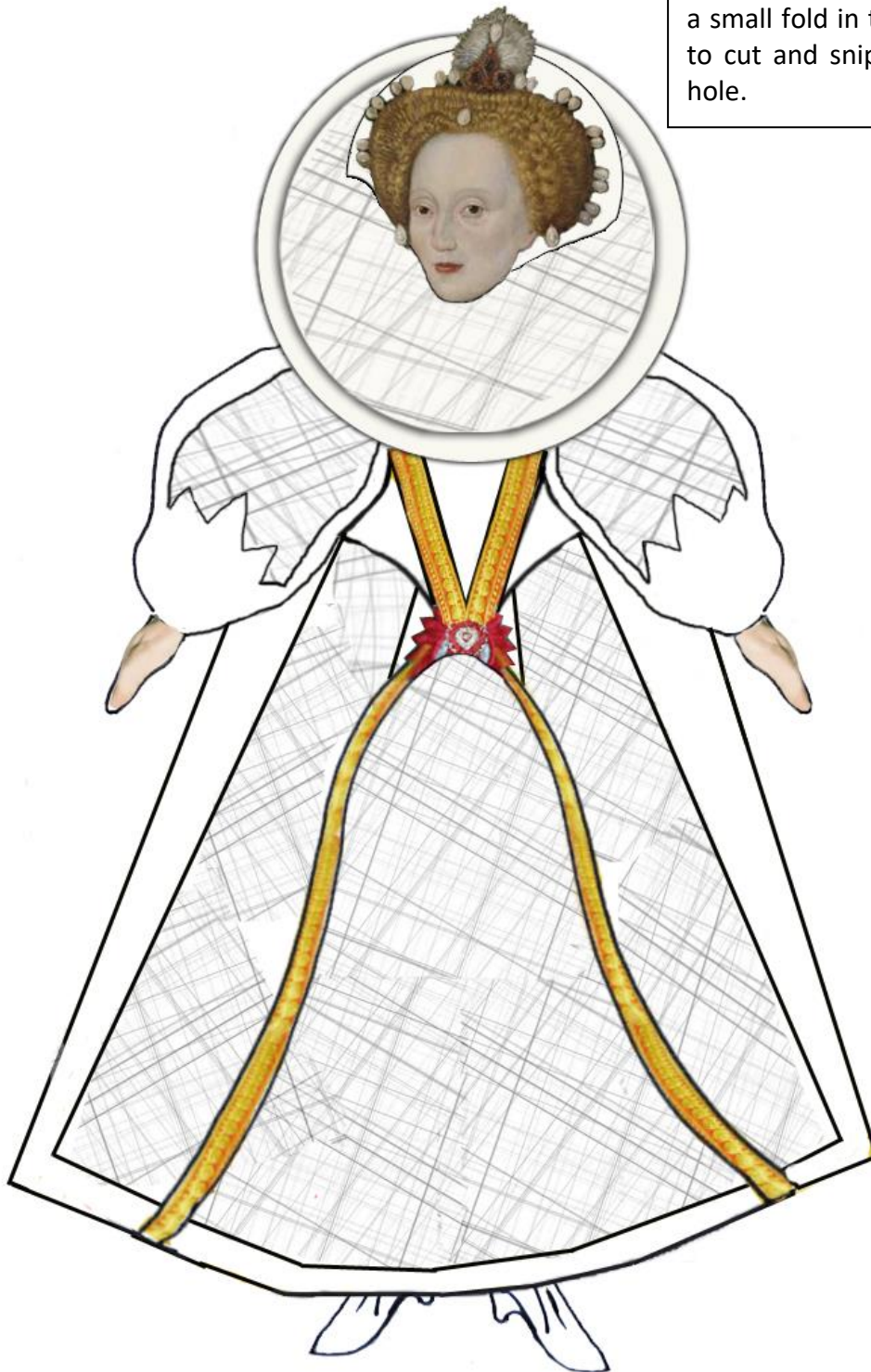

Next, create your garments by holding Elizabeth next to fabrics, natural objects and magazines of your choice, and take photographs.